

HD34167

Cavity Band Pass Filter

■ Mechanical Drawing

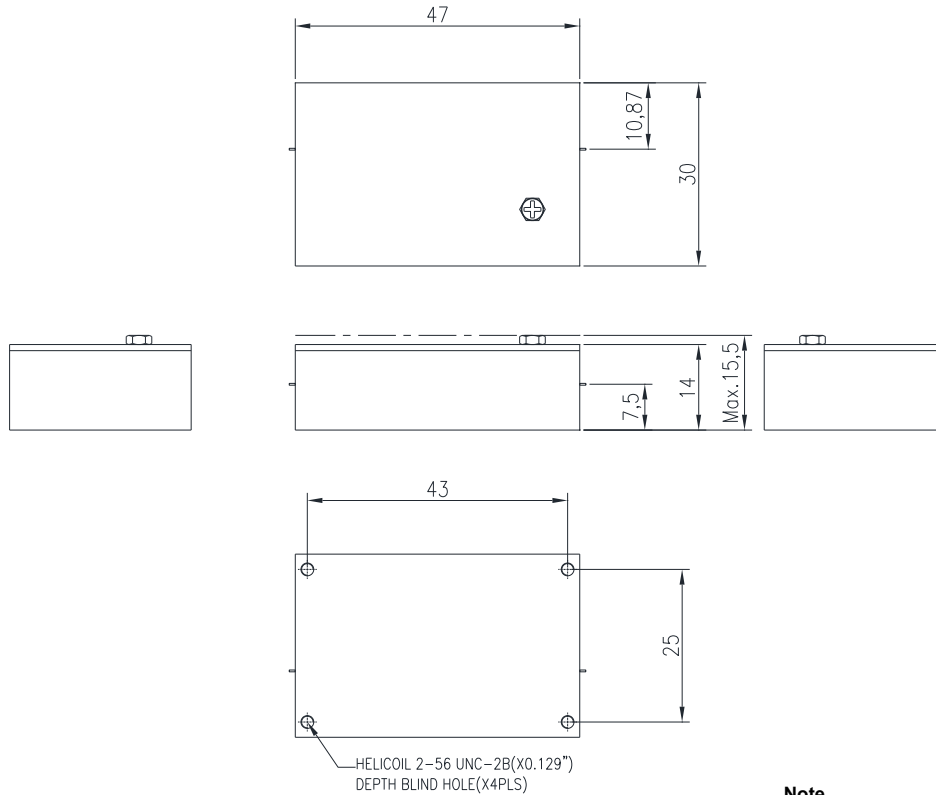

Note
 1. Connector :SMA(Removable)
 2. Finish :Silver Plated

■ Electrical Specification

Parameter	Specification	Remark
1. Center Frequency	2300MHz	
2. Frequency Range	fo ±100[2200~2400]MHz	
3. Insertion Loss	0.65dB Max.	

HD34167

Cavity Band Pass Filter

4. Return Loss	15dB Min.	
5. Rejection	65dBc Min@DC~1800MHz	
	36dBc Min@2000MHz	
	20dBc Min@2500MHz	
	40dBc Min@2700~7000MHz	
	56dBc Min@7200MHz	
6. Size	47.0x30.0x15.5 mm	
7. Input RF Power	50W Avg.Max.	
8. Impedance	50Ω	
9. Mounting	Drop -in	
10. Operation Temperature Range	-50°C to +85°C	

Test Curve

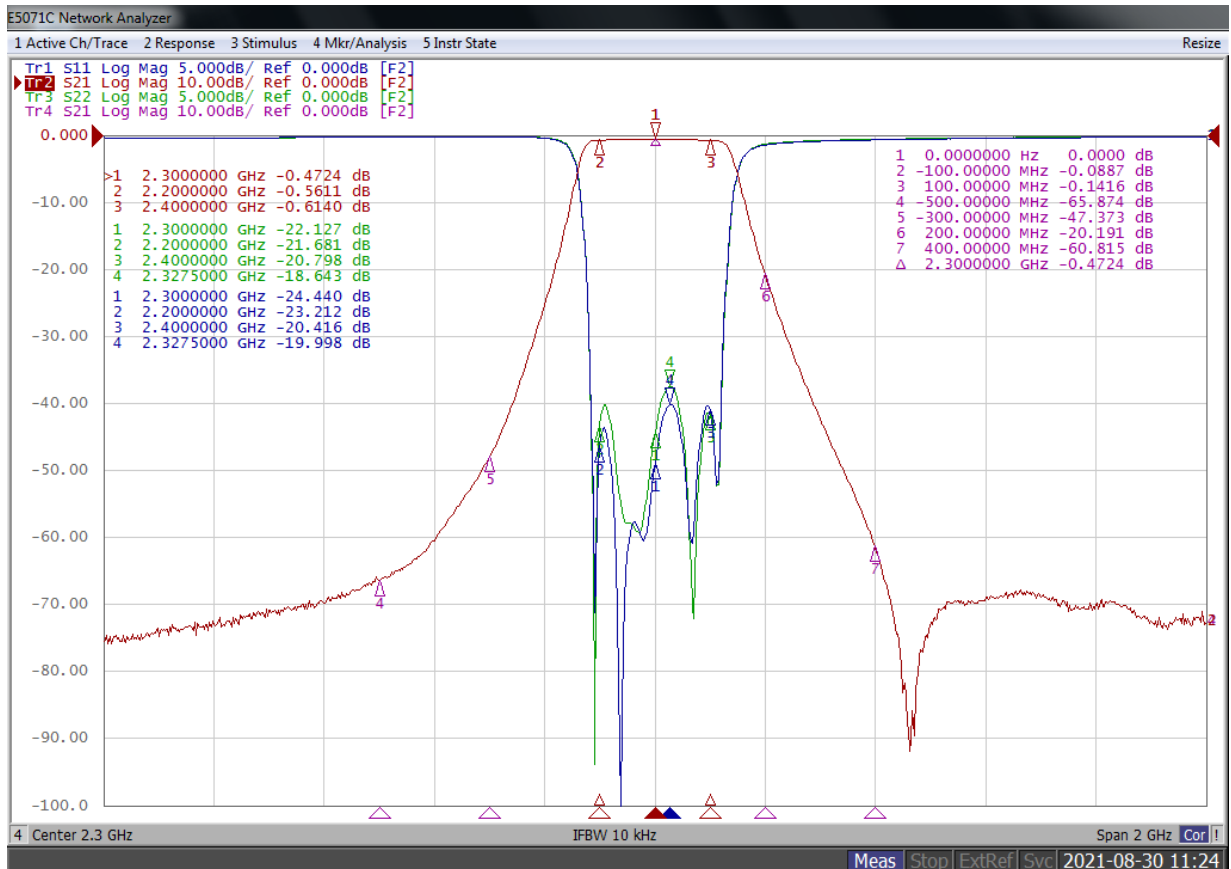

HD34167

Cavity Band Pass Filter

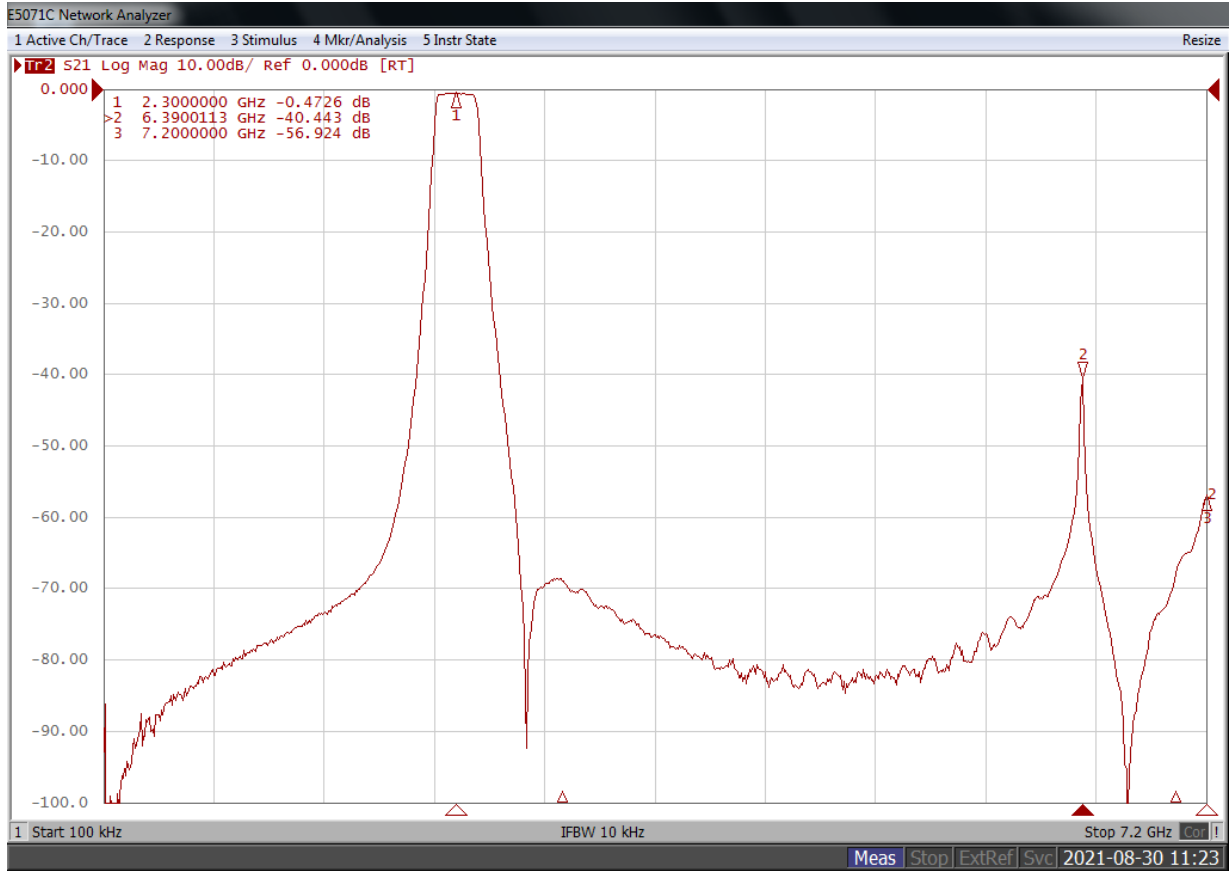

338 Jericho Tpke. Ste 387, Syosset, NY 11791

Tel: (631) 588-3877 Email: sales@hdcom.com

© COPYRIGHT 2008-2023 HD Communications Corp.

All rights reserved. Redistribution or republication of these pages in any form requires express written consent.