

PRELIMINARY SPECIFICATION

**Product Name : LC Band Pass Filter**

**Part No : HD34338**

## PRODUCT SPECIFICATION FOR INFORMATION

### ■ Mechanical Drawing

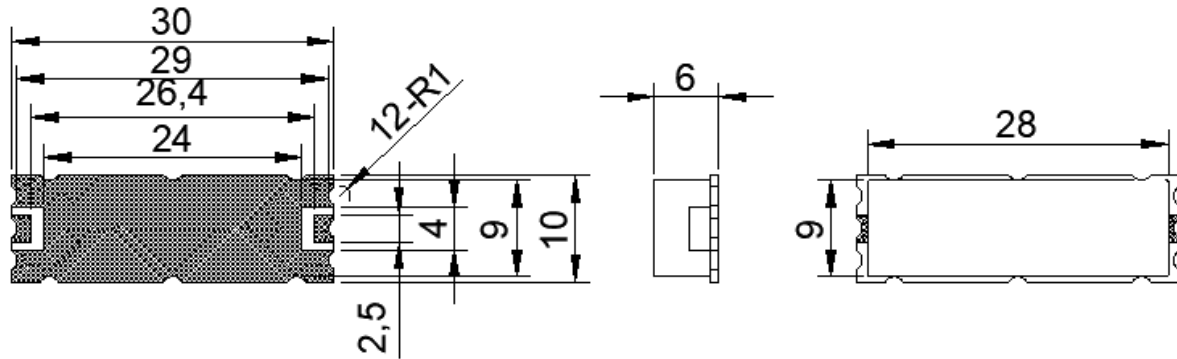

### Note

1. Connector : SMD
2. Pin Plating : Au
3. Finish : Ag Plating

### ■ Electrical Specification

Parameter	Specification	Remark
1. Center Frequency	386.5MHz	
2. Pass Band Frequency	C.F±143.5MHz[225~512MHz]	
3. Insertion Loss	2.0dB Max.	
4. Ripple	1.0dB Max.	
5. Return Loss	13dB Min.	
6. Attenuation[Absolute Value]	30dBc min. @ DC-190MHz	
	30dBc min. @ 600MHz	
	60dBc min. @ 900-1250MHz	
7. Group Delay Ripple	10ns Max.	
8. Size	30 x 10 x 6 mm	
9. Connector	SMD	
10. Input RF Power	20dBm	
11. Impedance	50Ω	
12. Operation Temperature Range	-40°C to +85°C	

Remarks: This is a preliminary datasheet for reference. The final performance is subject to the sample.